



**UNIT
PLANS**

2 BHK

799 SFT

795 SFT

3 BHK

1068 SFT

1043 SFT

UNIT DISTRIBUTION PLAN

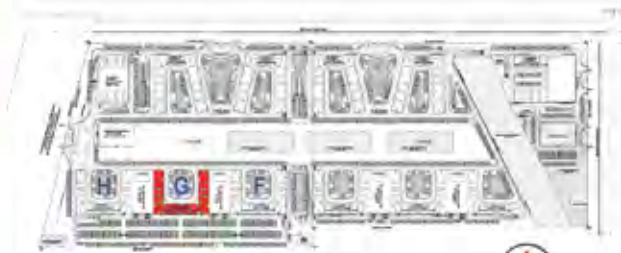

KEY PLAN



LEGEND

- TYPE - A 3 BHK UNIT
- TYPE - A1 3 BHK UNIT
- TYPE - A2 3 BHK UNIT
- TYPE - B 2 BHK UNIT
- TYPE - B1 2 BHK UNIT

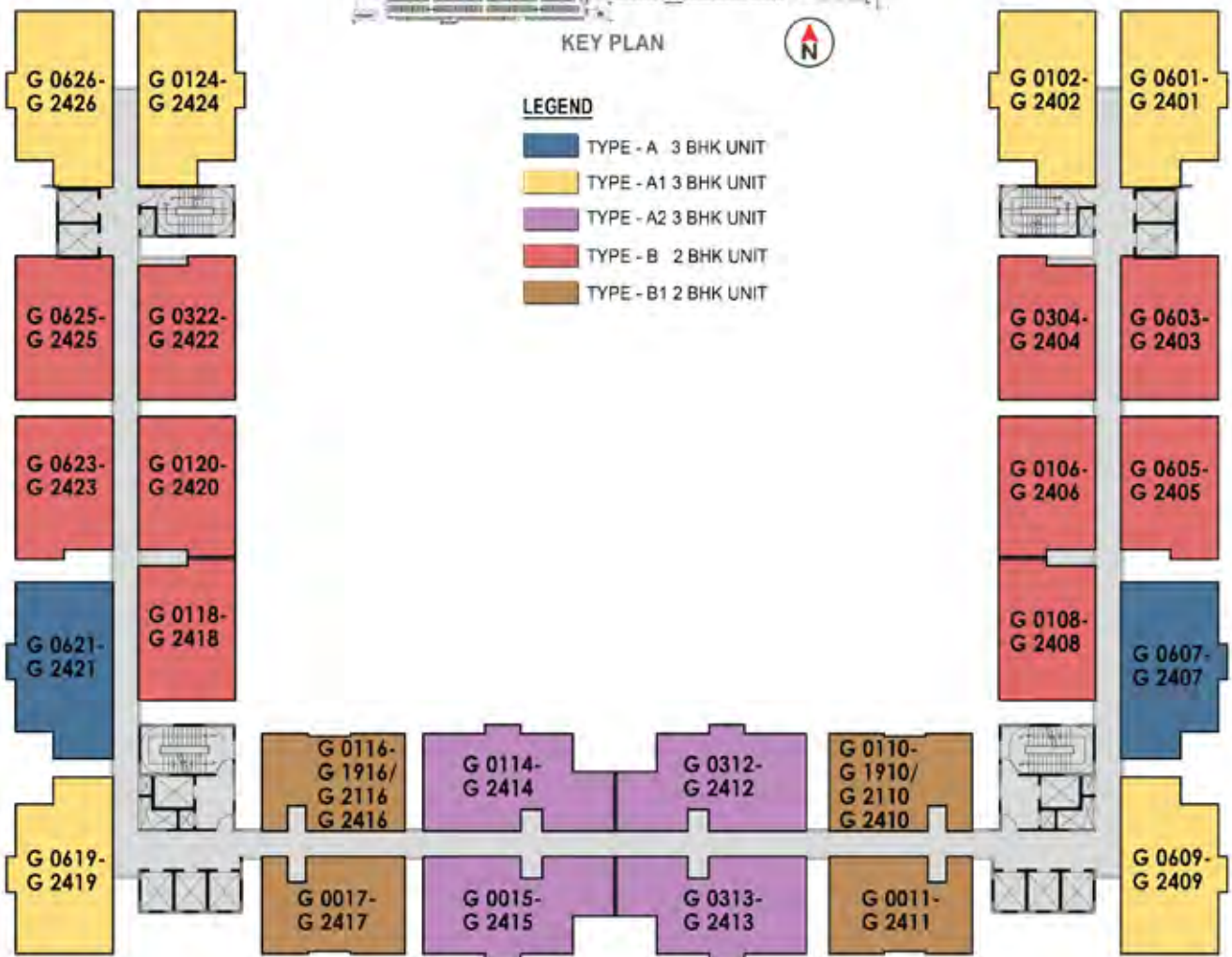

The information depicted herein viz., master plans, floor plans, furniture layout, fittings, illustrations, specifications, designs, dimensions, rendered views, colours, amenities and facilities etc., are subject to change without notifications as may be required by the relevant authorities or the developer's architect, and cannot form part of an offer or contract. Whilst every care is taken in providing this information, the Developer cannot be held liable for variations. All illustrations and pictures are artist's impression only.

The information are subject to variations, additions, deletions, substitutions and modifications as may be recommended by the company's architect and/or the relevant approving authorities. The Developer is wholly exempt from any liability on account of any claim in this regard. (1 square metre = 10.764 square feet). E & OE.

2 BEDROOM UNIT - (TYPE - B)

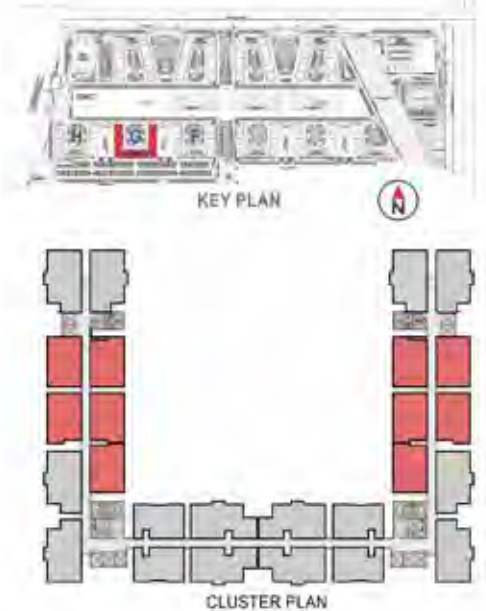

SUPER BUILT-UP AREA	CARPET AREA	BALCONY
795 Sq.ft / 73.86 Sq.m.	466 Sq.ft / 43.32 Sq.m	16 Sq.ft / 1.512 Sqm

UNITS
G-0603-2403, G-0304-2404, G-0605-2405, G-0106-2406, G-0108-2408, G-0118-2418, G-0120-2420, G-0322-2422, G-0623-2423, G-0625-2425

The information depicted herein viz., master plans, floor plans, furniture layout, fittings, illustrations, specifications, designs, dimensions, rendered views, colours, amenities and facilities etc., are subject to change without notifications as may be required by the relevant authorities or the developer's architect, and cannot form part of an offer or contract. Whilst every care is taken in providing this information, the Developer cannot be held liable for variations. All illustrations and pictures are artist's impression only.

The information are subject to variations, additions, deletions, substitutions and modifications as may be recommended by the company's architect and/or the relevant approving authorities. The Developer is wholly exempt from any liability on account of any claim in this regard. (1 square metre = 10.764 square feet). E & OE.

2 BEDROOM UNIT - (TYPE - B1)



SUPER BUILT-UP AREA	CARPET AREA	BALCONY
799 Sq.ft / 74.23 Sq.m.	471 Sq.ft / 43.72 Sq.m	12 Sq.ft / 1.1 Sqm

UNITS
G-0116-1916/ 2116-2416, G-0110-1910/ 2110-2410, G-0011-2411, G-0017-2417

The information depicted herein viz., master plans, floor plans, furniture layout, fittings, illustrations, specifications, designs, dimensions, rendered views, colours, amenities and facilities etc., are subject to change without notifications as may be required by the relevant authorities or the developer's architect, and cannot form part of an offer or contract. Whilst every care is taken in providing this information, the Developer cannot be held liable for variations. All illustrations and pictures are artist's impression only.

The information are subject to variations, additions, deletions, substitutions and modifications as may be recommended by the company's architect and/or the relevant approving authorities. The Developer is wholly exempt from any liability on account of any claim in this regard. (1 square metre = 10.764 square feet). E & OE.

3 BEDROOM UNIT - (TYPE - A)

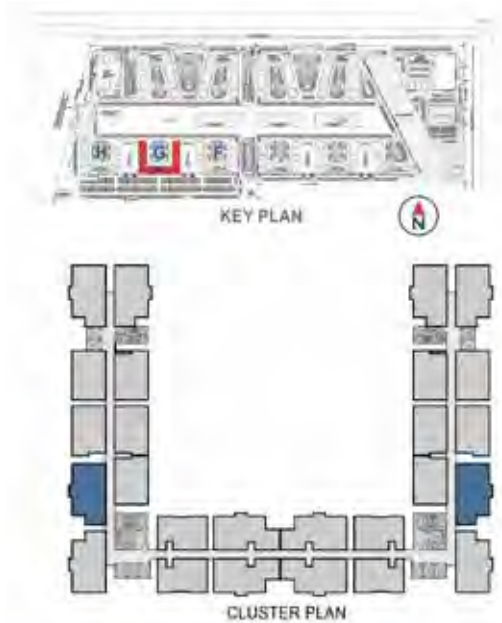

SUPER BUILT-UP AREA	CARPET AREA	BALCONY
1043 Sq.ft / 96.90 Sq.m.	628 Sq.ft / 58.31 Sq.m	11 Sq.ft / 1.05 Sqm

UNITS
G-0607-2407, G-0621-2421

The information depicted herein viz., master plans, floor plans, furniture layout, fittings, illustrations, specifications, designs, dimensions, rendered views, colours, amenities and facilities etc., are subject to change without notifications as may be required by the relevant authorities or the developer's architect, and cannot form part of an offer or contract. Whilst every care is taken in providing this information, the Developer cannot be held liable for variations. All illustrations and pictures are artist's impression only.

The information are subject to variations, additions, deletions, substitutions and modifications as may be recommended by the company's architect and/or the relevant approving authorities. The Developer is wholly exempt from any liability on account of any claim in this regard. (1 square metre = 10.764 square feet). E & OE.

3 BEDROOM UNIT - (TYPE - A1)

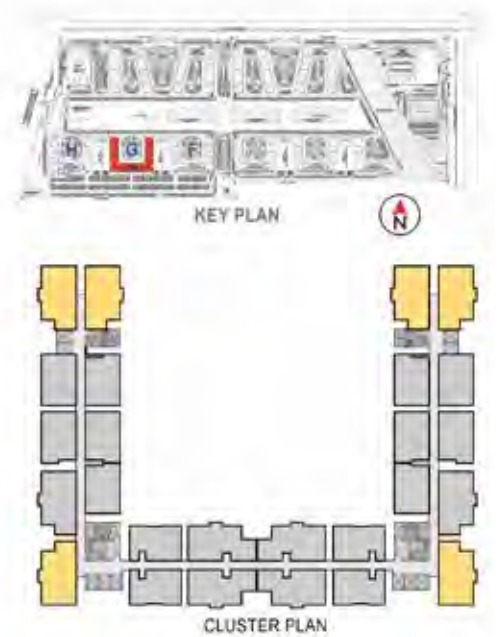

SUPER BUILT-UP AREA	CARPET AREA	BALCONY
1043 Sq.ft / 96.90 Sq.m.	628 Sq.ft / 58.31 Sq.m	11 Sq.ft / 1.05 Sqm

UNITS
G-0601-2401, G-0102-2402, G-0609-2409, G-0619-2419, G-0124-2424, G-0626-2426

The information depicted herein viz., master plans, floor plans, furniture layout, fittings, illustrations, specifications, designs, dimensions, rendered views, colours, amenities and facilities etc., are subject to change without notifications as may be required by the relevant authorities or the developer's architect, and cannot form part of an offer or contract. Whilst every care is taken in providing this information, the Developer cannot be held liable for variations. All illustrations and pictures are artist's impression only.

The information are subject to variations, additions, deletions, substitutions and modifications as may be recommended by the company's architect and/or the relevant approving authorities. The Developer is wholly exempt from any liability on account of any claim in this regard. (1 square metre = 10.764 square feet). E & OE.

3 BEDROOM UNIT - (TYPE - A2)

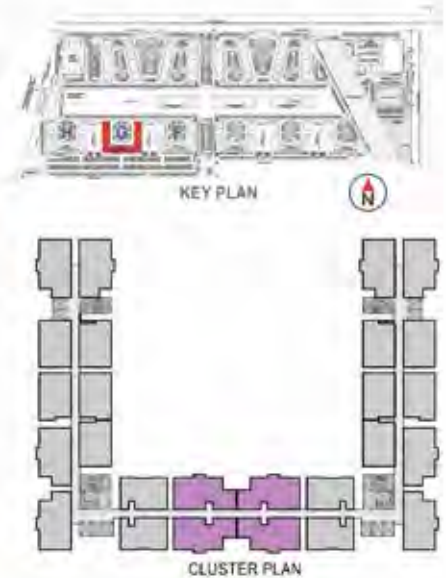

SUPER BUILT-UP AREA	CARPET AREA	BALCONY
1068 Sq.ft / 99.22 Sq.m.	643 Sq.ft / 59.69 Sq.m	11 Sq.ft / 1.05 Sqm

UNITS
G-0312-2412, G-0313-2413, G-0114-2414, G-0015-2415

The information depicted herein viz., master plans, floor plans, furniture layout, fittings, illustrations, specifications, designs, dimensions, rendered views, colours, amenities and facilities etc., are subject to change without notifications as may be required by the relevant authorities or the developer's architect, and cannot form part of an offer or contract. Whilst every care is taken in providing this information, the Developer cannot be held liable for variations. All illustrations and pictures are artist's impression only.

The information are subject to variations, additions, deletions, substitutions and modifications as may be recommended by the company's architect and/or the relevant approving authorities. The Developer is wholly exempt from any liability on account of any claim in this regard. (1 square metre = 10.764 square feet). E & OE.