

**“IF ONLY MY
DAD WERE
AROUND TO
SEE ME WIN.**

**BUT HE’S
TOO BUSY
ON THE
BASKETBALL
COURT.”**

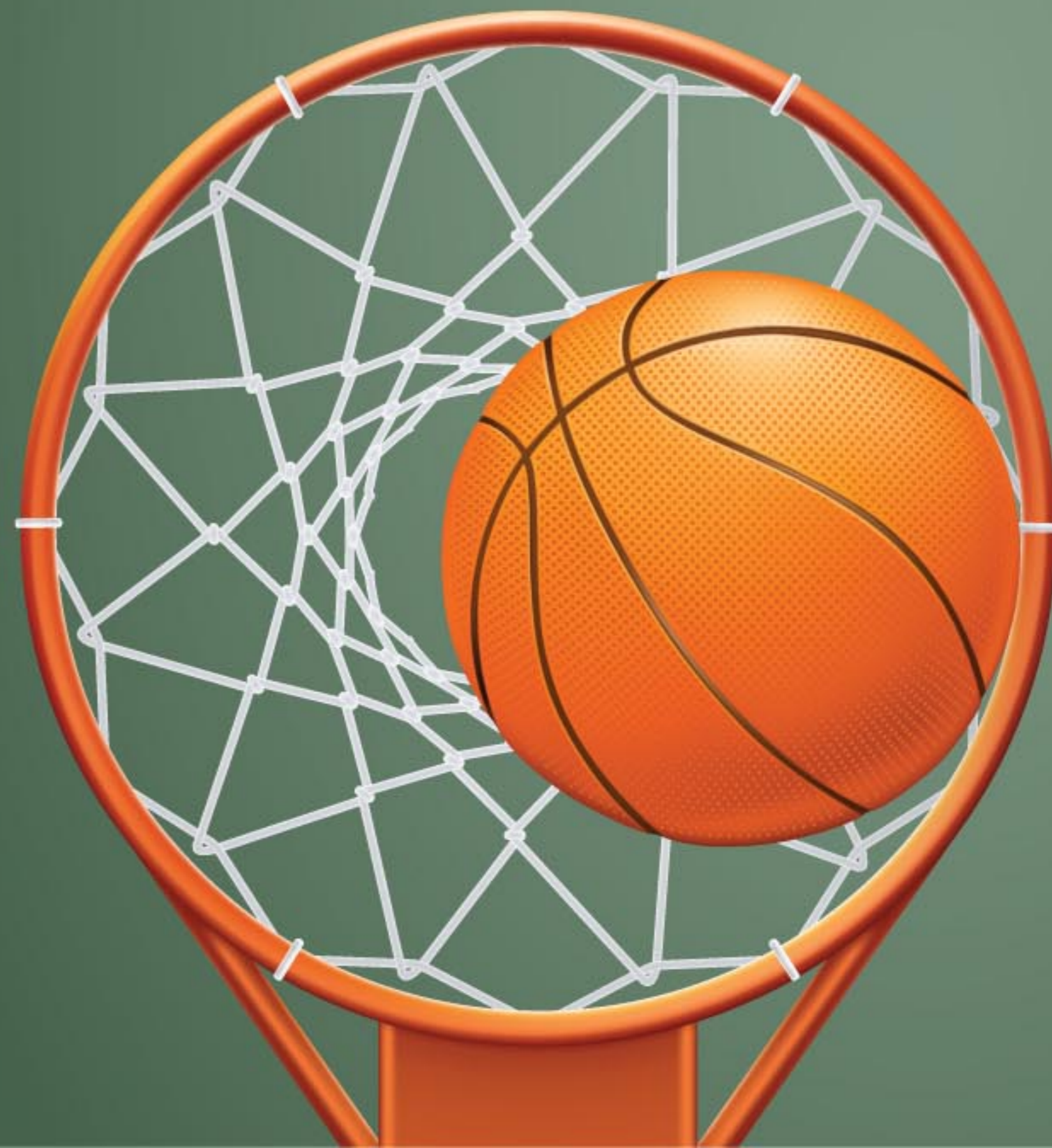

Arvind
SPORCIA

STAY WHERE YOU *PLAY*

DUNK ◦ *DRIVE* ◦ *SMASH* ◦ *VOLLEY* ◦ *SPIKE*

HOMES ATTACHED TO SPORTS FACILITIES



US NBA Jr. School
Approved Size Court



ICC Standard Size
22 Yard Cricket Pitch



Table Tennis



World Squash Federation
Approved Size Court



Volleyball
Court



Swimming Pool



Pool Table



International
Tennis Federation
Approved Size Court



Internationally
Approved
Equipments



Paddle
Tennis Court



You've lived in our clothes. Now live in our homes. Arvind Real Estate, a part of Arvind Ltd.(one of the largest manufacturer of denim in the world), presents

Arvind Sporcias.

Located in the most upcoming part of Bangalore city, North Bangalore, behind Manyata Tech. Park at Hebbal, Sporcias provides a unique opportunity for the residents to embrace a healthy and engaged lifestyle with its international size integrated sports facilities and trained coaching facilities.

Each and every home at Sporcias is attached to one or the other sports facility. Open the front door or stand in the balcony of your apartment to feel the vibrancy around you or just step out from the pavilion and be a part of it.

**You've lived in our clothes.
Now live in our homes.**



STAY WHERE YOU *DUNK*

OUR BASKETBALL COURT COMES
ATTACHED WITH 2 & 3 BHK APARTMENTS



OUR CRICKET PITCH COMES
ATTACHED WITH 2 & 3 BHK APARTMENTS



STAY WHERE YOU *DRIVE*



OUR SQUASH COURT COMES
ATTACHED WITH 2 & 3 BHK APARTMENTS



Arvind
SPORCIA

STAY WHERE YOU PLAY

STAY WHERE YOU VOLLEY

OUR TENNIS COURT COMES
ATTACHED WITH 2 & 3 BHK APARTMENTS



OUR VOLLEYBALL COURT COMES
ATTACHED WITH 2 & 3 BHK APARTMENTS





Arvind 
SPORCIA

STAY WHERE YOU PLAY



Arvind 
SPORCIA

STAY WHERE YOU PLAY



SPORCIA

Grand Central Garden with Pool & Club house

Specifications:

- 1 Structure**
 - Earthquake resistant RCC frame structure
 - External and internal partition walls with good quality fly ash cement blocks/clay bricks.
- 2 Flooring**
 - Living, Dining & Bedrooms: 300x300 vitrified tiles of Kajaria/Somany/Nitco/Simpolo or equivalent make
 - Master Bedroom: 300x300 vitrified tiles of Kajaria/Somany/Nitco/Simpolo or equivalent make
 - Kitchen, Balcony, Toilets, Utilities, Lift Lobby: Ceramic Tiles
 - Staircase: Tandoor/Kota/ any other equivalent Stone
 - Balcony: Wood Finish tiles
- 3 Staircase**
 - Tandoor/Kota/ any other local equivalent Stone
 - Railing: Mild Steel Hand Rail
- 4 Windows**
 - 2 track Powder coated aluminium with float glass and grill-Jindal or equivalent make
 - Balcony: 3 track aluminium section-Jindal or equivalent make
- 5 Door**
 - Main Door: Wooden door with Teak Wood finish
 - Internal Rooms: Flush Doors with Laminate
- 6 Electrical**
 - Television point in living & all bedrooms
 - Provision for telephone/Internet connection in Living room & all other Bedrooms
 - AC point in Living room & all other Bedrooms
 - Power points for refrigerator & Microwave in Kitchen and Washing machine in Utility
 - All Switch Gears to be of L&T/Schneider/Havells/Siemens or equivalent make
 - Elevators of Schindler/Kone/Thyssenkrupp or equivalent make
 - Internal wiring of Havells/Anchor/Polycab/Finolex or equivalent make
- 7 Wall Finish**
 - Internal: Jotun/Asian/ICI Dulux/Nerolac or equivalent make
 - External: Acrylic Paint
- 8 Platforms**
 - Kitchen: Black Polished Granite
 - Bathrooms: Granite/Marble
- 9 Toilet**
 - All CP fittings and accessories of Jaquar/Plumber/Cera or equivalent make
 - Wall/floor mounted sanitary ware of Cera/Jaguar/Hindware/Parryware or equivalent make

Amenities / Facilities

- 1 Outdoor Sports**
 - Tennis Court
 - Basketball
 - Volley Ball
 - Cricket pitch
 - Paddle Tennis
 - Skating Rink
 - Sand-pit/Children's Play Area
 - Swimming Pool
 - Toddlers Pool
- 2 Indoor Sports**
 - Squash
 - Pool Table
 - Table Tennis
 - Carom
 - Darts
- 3 Entertainment**
 - Amphitheatre
 - Restaurant & café
 - Chill-out Lounge
- 4 Health**
 - Gymnasium
 - Steam, Sauna & Jacuzzi
 - Jogging track
 - Yoga, Meditation & Aerobics Room
 - Yoga and Sports training facility by trained professionals/coaches
- 5 Security system**
 - Boom-Barrier Entry
 - CCTV
 - Access Control at every Gate
 - Intercom facility in security cabins linked with all apartments
 - Public address system (with mike in Lobby reception) for calling drivers from parking
- 6 Landscape**
 - Walkways
 - Water Bodies
 - Fountains
 - Senior Citizen's Park
- 7 Other Value Addition**
 - Grocery Store
 - Medical Store
 - Ample Parking
 - Crèche
 - Dual Plumbing System
 - 24 Hours Power Back-Up

Master Layout Plan



LEGEND

- ① ENTRY GATE
- ② LANDSCAPE GARDEN
- ③ WATER BODY WITH FOUNTAIN
- ④ LILY POND
- ⑤ SWIMMING POOL
- ⑥ GAZEBO
- ⑦ CRICKET PITCH
- ⑧ SKATING RINK
- ⑨ JUNIOR BASKETBALL COURT
- ⑩ TENNIS COURT
- ⑪ VOLLEY BALL COURT/PADDLE TENNIS COURT
- ⑫ STEPPED SEATING/AMPHITHEATRE
- ⑬ SENIOR CITIZEN AREA
- ⑭ KIDS PLAY AREA
- ⑮ CLUB HOUSE
- ⑯ RAMP IN
- ⑰ RAMP OUT
- ⑱ EXIT GATE

Floor Plan: 2 BHK Compact
 Block A: All Units
 Saleable Area: 753 Sq Ft



Floor Plan: 2 BHK
 Unit No.: C-004 to C-1404
 D-001 to D-1401
 Saleable Area: 1016 Sq Ft

Floor Plans

Floor Plan: 2 BHK
 Unit No.: C-001 to C-1401
 Saleable Area: 1081 Sq Ft

ARVIND
SPORCIA
 STAY WHERE YOU PLAY



Floor Plan: 2 BHK
 Unit No.: C-102 to C-1402
 C-103 to C-1403
 D-102 to D-1402
 Saleable Area: 1016 Sq Ft

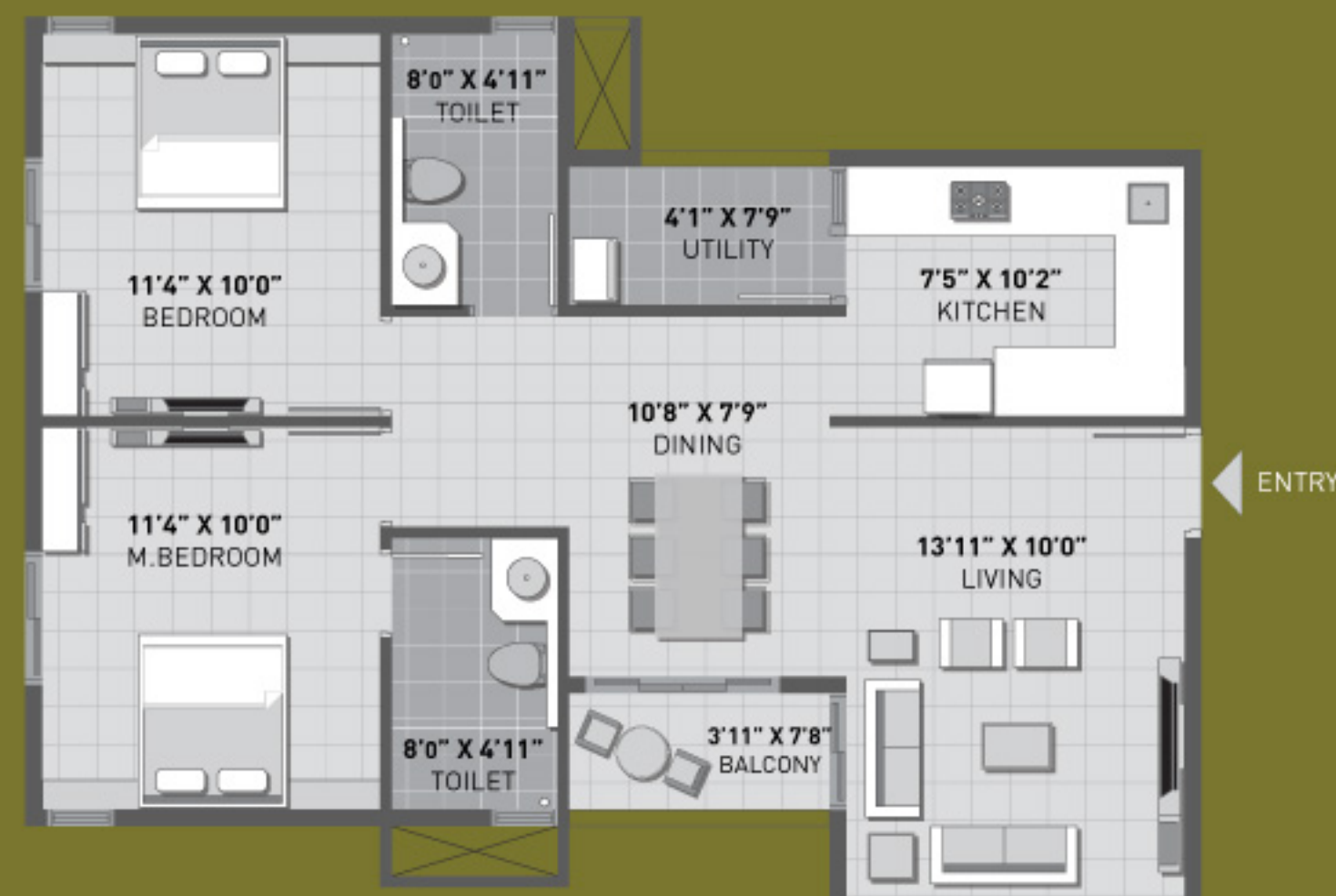

Floor Plan: 2 BHK
 Unit No.: D-003 to D-1403
 Saleable Area: 1024 Sq Ft



Floor Plans

Floor Plan: 2 BHK
 Unit No.: D-004
 Saleable Area: 1066 Sq Ft



Floor Plan: 2 BHK
 Unit No.: D-104 to D-1404
 Saleable Area: 1087 Sq Ft



Floor Plan: 2 BHK
 Unit No.: E-001 to 1401
 Saleable Area: 1088 Sq Ft



Floor Plan: 2 BHK
 Unit No.: E-004 to 1404
 Saleable Area: 1031 Sq Ft



Floor Plans

Floor Plan: 3 BHK Compact
Unit No.: B-101 to B-1401
B-202 to B-1402
Saleable Area: 1331 Sq Ft



Floor Plan: 3 BHK Compact
Unit No.: B-204 to B-1404
B-103 to B-1403
Saleable Area: 1246 Sq Ft



Floor Plan: 3 BHK Compact
Unit No.: C-006 to C-1406
Saleable Area: 1253 Sq Ft



Floor Plan: 3 BHK
Unit No.: C-005 to C-1405
Saleable Area: 1370 Sq Ft



OUR HISTORY

- 2009-10** Arvind forays into real estate in a big way announcing mega projects including a 90 million sq. ft. residential township in Ahmedabad.
- 2005-09** Arvind creates an aggressive retail strategy. A one-stop shop service is set up on a global scale, offering garment packages to reputed national and international customers. Arvind seeks new partnerships and strengthens its international portfolio consistently, with brands such as Lee, US Polo, etc.. It also commissions India's first ammonia treatment plant for high-end fashion fabrics.
- 1996-97** Arvind produces 100 million meters of Denim annually and becomes the third largest producer in the world. It sets up India's largest state-of-the-art facility for shirting, gabardine and knits at Santej.
- 1980-88** Arvind rides out the textile industry crisis, records highest levels of profitability and enters the export market for Denims.
- 1931-34** Arvind Mills Limited is set up by three brothers with the aim to produce high-end superfine fabrics and establishes itself amongst the foremost textile units in the country with sales reaching 45.76 lakhs.

ABOUT ARVIND

The Arvind legacy spans more than 80 years, and entails a spirited journey that led us through diverse challenges to achieve a remarkable success. Today Arvind is a one billion dollar conglomerate. Over this journey of more than eight decades we have emerged as leaders in the textile industry in India and have become the third largest denim manufacturer in the world. Arvind has been defining and shaping many collections and trendsetting styles across the ramps and retail outlets in the fashion capitals across the world. Arvind is today synonymous with a vast range of lifestyles products - be it fabrics or apparels. Even as focussed on enriching lifestyles by creating scores of globally acclaimed lifestyle brands, we diversified successfully into retail, engineering, telecommunications and real estate. In all these years, we set our sights firmly on one goal: Excellence.

Arvind touches everyday life to bring in that feel of excellence through the brands we all love so much. Flying Machine, Megamart-The Retail Chain, Tommy Hilfiger, US Polo, Arrow, Izod, Gantt, Nautica to name a few.

And now lifestyle spaces built with the same excellence and founded on the same trust.

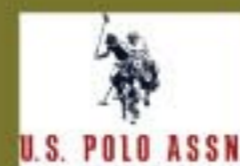

ONGOING PROJECTS



A premium 5BHK villas and 4BHK apartments scheme designed by world renowned architects HOK (USA) at Mahadevpura, Whitefield, Bangalore.



Located near Rancharda, Ahmedabad, Uplands is a high end low density golf living project having premium villas built around a stylish golf course and a lifestyle club. Designed by world renowned architects, Woods Bagot (HongKong), Uplands is for the select few and of the select few.



Parishkaar is spread over 7 acres of land on a sprawling "Arvind Avenue" campus of 21 acres. Located in East Maninagar - the heart of Ahmedabad, the project comprises of more than 700 elite 2 & 3 BHK lifestyle apartments & a premium commercial complex.



A premium weekend residential scheme, Alcove is situated at Village Shanawad in the western suburbs of Ahmedabad covering more than 24 acres of land. It boasts of the best in its class, state-of-the-art facilities including RCC roads, integrated sewage system, and a furnished club house of more than 12,000 sq. ft.



Welcome to a home that not just offers you a world of comfort and convenience, but is a definitive upgrade to your lifestyle. It's a part of an integrated green sustainable township at Vadsar, Ahmedabad which is futuristic in its outlook and yet retains the true essence of Gujarat.



Shubh Griha is the first phase of an integrated green sustainable 135-acre township at Vadsar, Ahmedabad whose every feature - right from the layout and design to the architecture and construction - is inspired by and reminiscent of the cultural splendor of Gujarat.



A commercial complex of 234 exclusive Shops and Offices on Naroda Road, Ahmedabad - situated near Ahmedabad's business hub, designed to take your business to the next level.



Opening out into the bustling Khokhra circle, it is the most happening commercial zone in East Maninagar. It offers the advantage of a ready customer-base with more than 1300 families, all within one campus.



Arvind Citadel offers you a quality time to ourselves, our family and friends. It gives the choice of 3 & 4BHK lifestyle apartments that are centrally located in the heart of Ahmedabad city off CG Road. Citadel is at two minutes distance from the business centers, offices, schools, malls, supermarkets, hotels, hospitals and everything else that we need in our life.



Arvind Megaestate is a large size mixed-used commercial development spread over 30 acres of land on the main Naroda Road. Developed by Arvind Infrastructure Limited, this world-class development is envisaged to be a self-sufficient and integrated business zone of East Ahmedabad.



Beyond Five takes the whole concept of weekend homes a notch above. Designed by Woods Bagot (HongKong), this project contains a bouquet of premium features like a 9 hole golf course, smash cricket and much more. Located at Moti Devti near Sanand, Ahmedabad, Beyond Five offers premium golf weekend homes and residential plots spread over 170 acres.



Situated in the industrial hub of Changodar(Chancharwadi area), Arvind MEGAPARK houses industrial plots and industrial sheds for large, medium and small scale enterprises. It is spread over 20 acres of sprawling area in the web of some major industrial spaces.



White by Arvind is a premium weekend homes and residential plotting scheme at Chekhla, Sanand-Kadi Road, Ahmedabad. Spread over vast expanse of 1,50,000 sq. yards, nestled in nature, White is an oasis of peace.



The mark of true craftsmen is the pride they take in their creation. It is the passion for their craft that drives them to surpass the norms of acceptability and explore the very limits of perfection. And the ultimate reward for the craft is the joy it delivers to the end user. At Arvind Infrastructure, the quality of our craft and the joy it brings to your life is a matter of pride for us. That's why we believe in first delivering impeccable quality, and therefore delivering pure joy to our customers. You will see this in the precision of our processes, simplicity of our transactions, truth in our promises and thoughtfulness in everything we build.

ARVIND INFRASTRUCTURE - BUILDING PRIDE.BUILDING JOY.



Head Office: 24, Govt. Servant Society, Behind Citibank, C.G. Road, Ahmedabad 380 009.

Contact: +91 9036288763 / +91 9844777700 / +91 9624019436/37 | Email: sporcia@arvind.com | Website: www.arvindinfra.com