

KEY PLAN

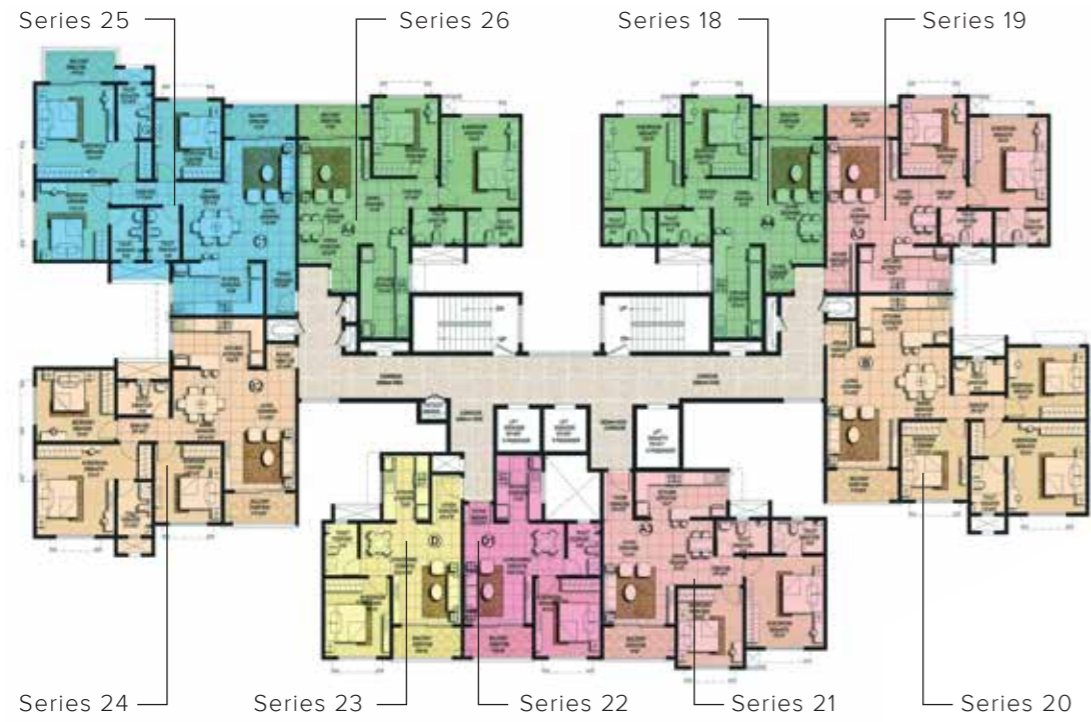

TYPICAL FLOOR PLAN (GROUND TO 22nd FLOOR, EXCEPT 3rd TO 8th) - TOWER C



KEY PLAN

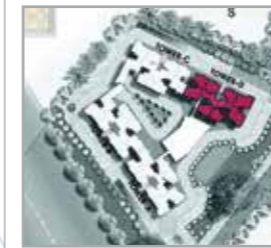

- 720 sq.ft.
- 1170 sq.ft.
- 1670 sq.ft.
- 760 sq.ft.
- 1200 sq.ft.
- 2440 sq.ft.
- 1150 sq.ft.
- 1500 sq.ft.

FLOOR PLAN

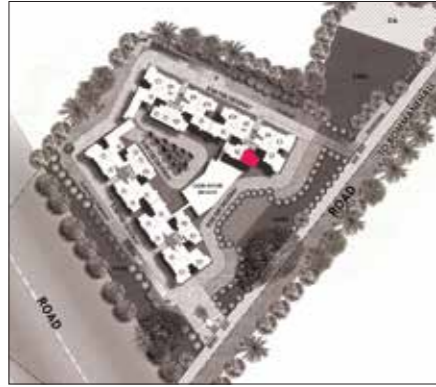

14 **2 BEDROOMS + 2 BATHROOMS // 107 sq.m (1150 sq.ft)**

As per Standards of Weights And Measures Act 1 sq mt. = 10.7639 sq ft.

FLOOR PLAN

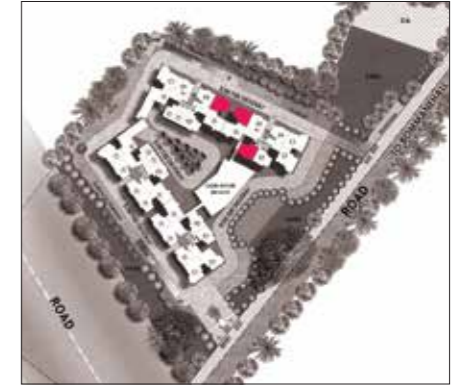

2 BEDROOMS + 2 BATHROOMS // 109 sq.m (1170 sq.ft) 15

As per Standards of Weights And Measures Act 1 sq mt. = 10.7639 sq ft.

FLOOR PLAN

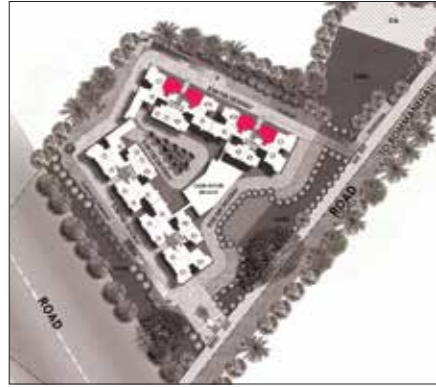

FLOOR PLAN

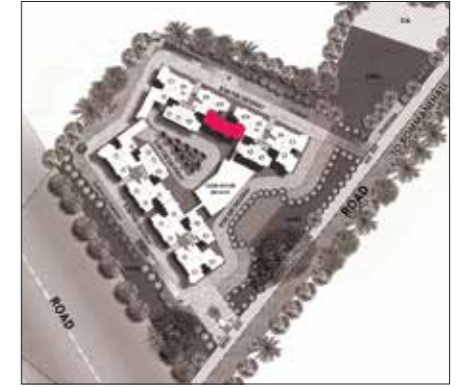

FLOOR PLAN

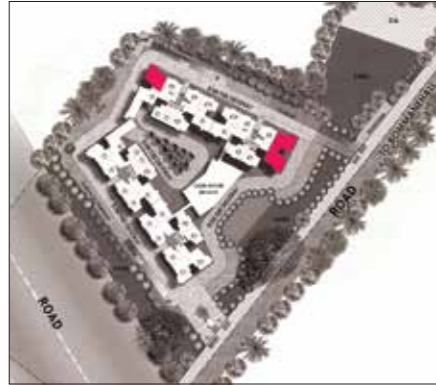

18

3 BEDROOMS + 3 BATHROOMS // 156 sq.m (1670 sq.ft)

As per Standards of Weights And Measures Act 1 sq mt. = 10.7639 sq ft.

FLOOR PLAN

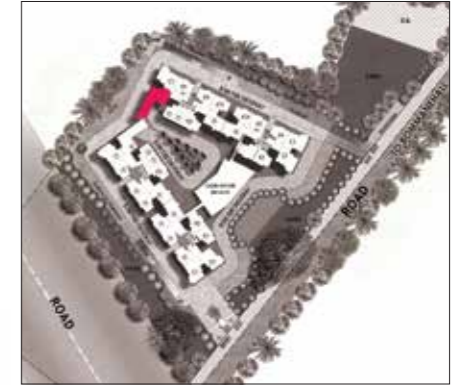

19

4 BEDROOMS + 4 BATHROOMS + FAMILY SPACE // 227 sq.m (2440 sq.ft)

As per Standards of Weights And Measures Act 1 sq mt. = 10.7639 sq ft.